

CDX-2CDX

Elettropompe centrifughe monogirante e bigirante costruite in acciaio inossidabile AISI 304, con motore asincrono 2 poli autoventilato.

CDX-2CDX

Single and twin impeller centrifugal pumps manufactured from stainless steel AISI 304, 2 poles self-ventilated asynchronous motor.



APPLICAZIONI

DOMESTICHE:

Impianti di Pressurizzazione
Alimentazione idrica
Giardinaggio

AGRICOLTURA

Media e piccola irrigazione a pioggia

INDUSTRIALI

Torri di raffreddamento
Impianti di irrigazione
Impianti di lavaggio
Alimentazione impianti

APPLICATIONS

DOMESTIC:

Booster sets
Water supply systems
Gardening

AGRICULTURE:

Sprinkler irrigation - Water subbly - Washdown

INDUSTRIAL:

Cooling water towers
Irrigation
Washing plants
Water supply systems

CARATTERISTICHE TECNICHE

Corpo pompa in acciaio inox AISI 304 con voluta esterna ottenuta con stampaggio ad espansione.

Giranti con pale saldate a proiezione in acciaio inox AISI 304.

Albero motore completamente in acciaio inox.

Il convogliatore e il diffusore (2CDX) totalmente in acciaio inox AISI 304, garantiscono delle caratteristiche meccaniche ed idrauliche superiori.

Supporto in alluminio (fino a 1.5 kW per 2CDX), in ghisa (da 2.2 kW e oltre); cassa motore in alluminio verniciato.

TECHNICAL FEATURES

The pump body manufactured by the innovative pressing system is made in AISI 304 stainless steel.

The impellers with blades projection-welded, are made in AISI 304 stainless steel.

Motor shaft completely in stainless steel, which comes in contact with the liquid. The intermediate conveyer and the diffuser (2CDX) are in stainless steel, giving greater strength and enhanced performance.

Motor bracket in aluminium (up to 1.5 kW for 2CDX), motor casing made of aluminium.

SIGLA IDENTIFICATIVA

Esempio: 2CDX

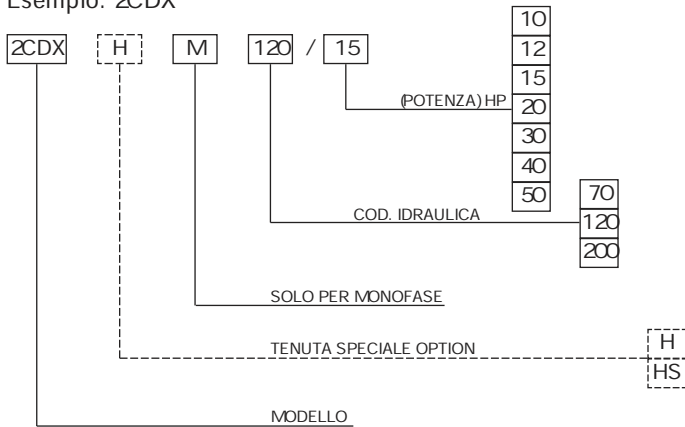

IDENTIFICATIONAL CODE

Example: 2CDX

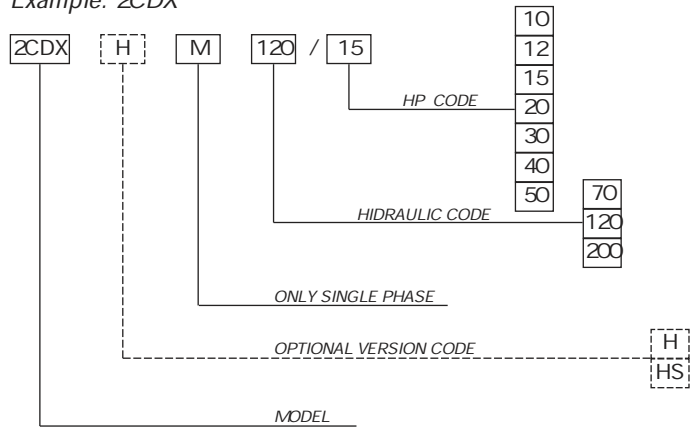

SPECIFICHE TECNICHE

SPECIFICATIONS

POMPA / PUMP			
Liquido / Liquid Handled	Tipo di liquido / Type of liquid	Acqua pulita / Clean water	
	Max temperatura / Max temperature [°C]	60 (CDX 70/05-70/07-90/10 e / and 2CDX) 90 (CDX 120/07, CDX 120/12, CDX 120/20, CDX 200/12, CDX 200/20, CDX 200/25) 110 (CDXH-CDXHS - 2CDXH-2CDXHS)	
	Temperatura minima / Min temperature [°C]	-10	
Pressione massima di esercizio / Maximum working pressure [MPa]	0.8		
Costruzione / Costruction	Girante / Impeller	Girante chiusa / Closed centrifugal type - Doppia / Twin (2CDX)	
	Tipo tenuta / Shaft seal type	Tenuta meccanica / Mechanical seal	
	Cuscinetti / Bearing	Cuscinetti schermati / Sealed ball bearing	
Conessioni / Pipe connection	Aspirazione / Suction	G1 1/4 (G 1 1/2 CDX 200 - 2CDX 200)	
	Mandata / Discharge	G1	
Materiale / Material	Corpo pompa / Casing	AISI 304	
	Girante / Impeller	AISI 304	
	Disco P/Tenuta / Casing cover	AISI 304	
	Tenuta meccanica / Shaft seal	Ceramica-Carbene-NBR / Ceramic-Carbon-NBR (CDX-2CDX) Ceramica-Carbene-FPM / Ceramic-Carbon-FPM (CDXH-2CDXH) SiC/SiC/FPM (CDXHS - 2CDXHS)	
	Albero / Shaft	AISI 303 (Wet extension) for CDX / AISI 304 (wet extension) for 2CDX	
	Supporto / Bracket	Alluminio / Aluminium (CDX) Alluminio / Aluminium (fino a / up to 1.5 kW incluso per / included for 2CDX) Ghisa / Cast iron (2.2 kW e oltre / and above for 2CDX)	
Diffusore / Diffuser	AISI 304 (2CDX)		
Standard di prova / Applicable standard of test	ISO 9906 Annex A		
Tipo / Type	Electric - TEFC		
	Monofase / Single Phase	Trifase / Three Phase	
No. di poli / No. of Poles	2		
R.P.M. / Rotation speed [min ⁻¹]	≈ 2800		
Grado di protezione / Insulation Class	F		
Grado di protezione / Protection degree	IP 55		
Potenze / Power rating	[kW]	0.37 ÷ 1.5 (CDX) 0.75 ÷ 1.5 (2CDX)	0.37 ÷ 1.8 (CDX) 0.75 ÷ 4 (2CDX)
	[HP]	0.5 ÷ 2 (CDX) 1 ÷ 2 (2CDX)	0.5 ÷ 2.5 (CDX) 1 ÷ 5.5 (2CDX)
Frequenza / Frequency [Hz]	50		
Voltaggio / Voltage [V]	230 ± 10%	230/400 ± 10%	
Condensatore / Capacitor	Incorporato / Built in	-	
Protezione / Over load protection	Incorporato / Built in	A cura dell'utente / Provided by the user	
Materiale del corpo pompa / Casing material	Aluminium		
Materiale base/supporto motore Base material/motor support	Aluminium		
Dimensioni cavo / Dimensions of cable entry	PG11 - PG13.5 - PG16 (2CDX)		

CAMPO DI IMPIEGO / SELECTION CHART

CDX



TABELLA PRESTAZIONI / PERFORMANCE TABLE

Modelli Type pumps		Potenza Power		Q = Portata/Capacity									
Monofase Single phase	Trifase Three phase	kW	HP	l/min 20	50	80	90	110	130	160	180	210	250
				m ³ /h 1.2	3	4.8	5.4	6.6	7.8	9.6	10.8	12.6	15
H = Prevalenza manometrica totale in m.c.a. H = Total manometric head in meters													
CDXM 70/05	CDX 70/05	0.37	0.5	20.7	18.4	15.9	15	-	-	-	-	-	-
CDXM 70/07	CDX 70/07	0.55	0.8	28	24.5	20.5	-	-	-	-	-	-	-
CDXM 90/10	CDX 90/10	0.75	1	30.3	27.2	23.6	22.3	19.5	-	-	-	-	-
CDXM 120/07	CDX 120/07	0.55	0.8	-	20.5	18.7	18.1	16.8	15.5	13.7	12.5	-	-
CDXM 120/12	CDX 120/12	0.9	1.2	-	29.5	27.1	26.1	24.3	22.4	19.5	-	-	-
CDXM 120/20	CDX 120/20	1.5	2	-	37.5	35.3	34.6	33.1	31.4	28.6	-	-	-
CDXM 200/12	CDX 200/12	0.9	1.2	-	-	20.6	20.2	19.5	18.5	17.1	16.1	14.6	12.5
CDXM 200/20	CDX 200/20	1.5	2	-	-	31	30.6	29.7	28.9	27.5	26.6	25.1	23
-	CDX 200/25	1.8	2.5	-	-	38	37.5	36.4	35.3	33.6	32.4	30.5	28

CAMPO DI IMPIEGO / SELECTION CHART

2CDX

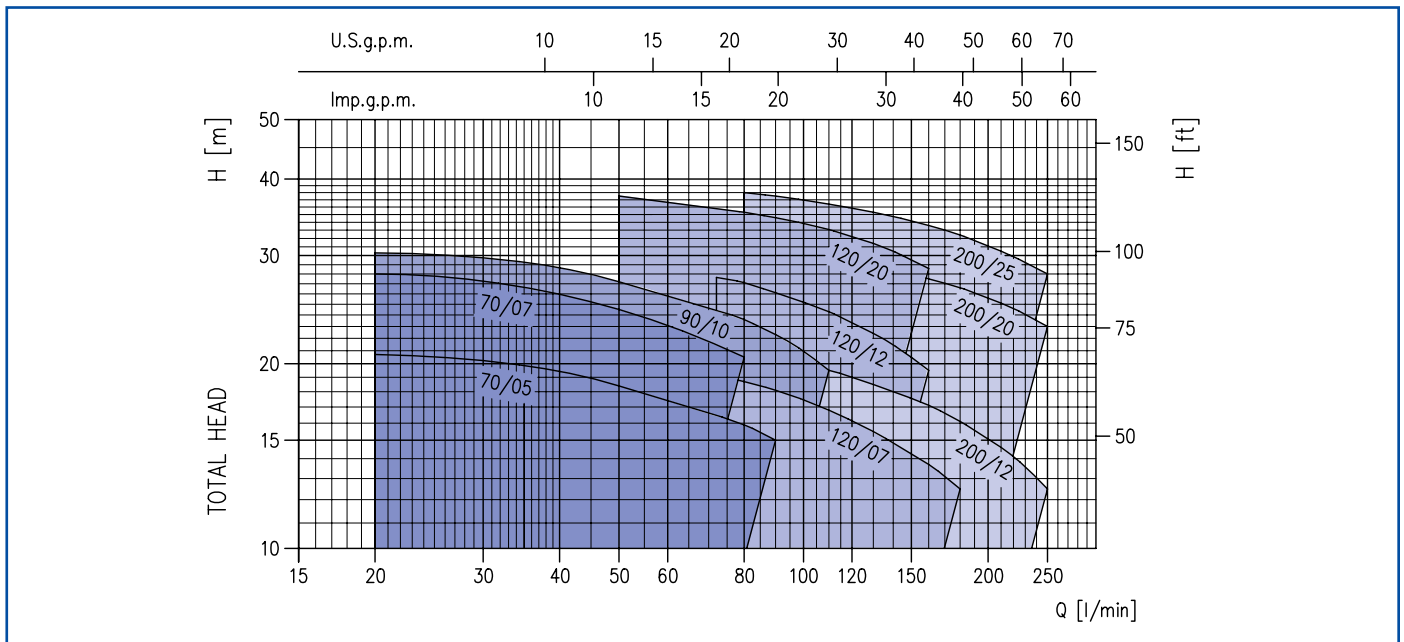

TABELLA PRESTAZIONI / PERFORMANCE TABLE

Modelli Type pumps		Potenza Power		Q = Portata/Capacity								
Monofase Single phase	Trifase Three phase	kW	HP	l/min	20	40	60	80	120	150	180	210
				m ³ /h	1.2	2.4	3.6	4.8	7.2	9.0	10.8	12.6
H = Prevalenza manometrica totale in m.c.a. H = Total manometric head in meters												
2CDXM 70/10	2CDX 70/10	0.75	1	38.5	35.3	31.5	27	-	-	-	-	-
2CDXM 70/12	2CDX 70/12	0.9	1.2	44.5	40.3	35.5	30	-	-	-	-	-
2CDXM 70/15	2CDX 70/15	1.1	1.5	52.5	48	42.8	36.5	-	-	-	-	-
2CDXM 70/20	2CDX 70/20	1.5	2	60	55.6	50.4	44	-	-	-	-	-
2CDXM 120/15	2CDX 120/15	1.1	1.5	-	42	41	39.5	35	30	-	-	-
2CDXM 120/20	2CDX 120/20	1.5	2	-	51.5	49.5	47.4	41.8	36.5	-	-	-
-	2CDX 120/30	2.2	3	-	59	57	54.6	49.2	44	-	-	-
-	2CDX 120/40	3	4	-	68.5	66.5	64	58	52	-	-	-
-	2CDX 200/30	2.2	3	-	-	52	50.8	48.1	45.5	42.7	39.5	-
-	2CDX 200/40	3	4	-	-	62.5	61.1	58	55.2	52.3	49	-
-	2CDX 200/50	3.7	5.5	-	-	71.5	70.1	67	64.3	61.2	57.5	-

CURVE DI PRESTAZIONE / PERFORMANCE CURVES

CDX

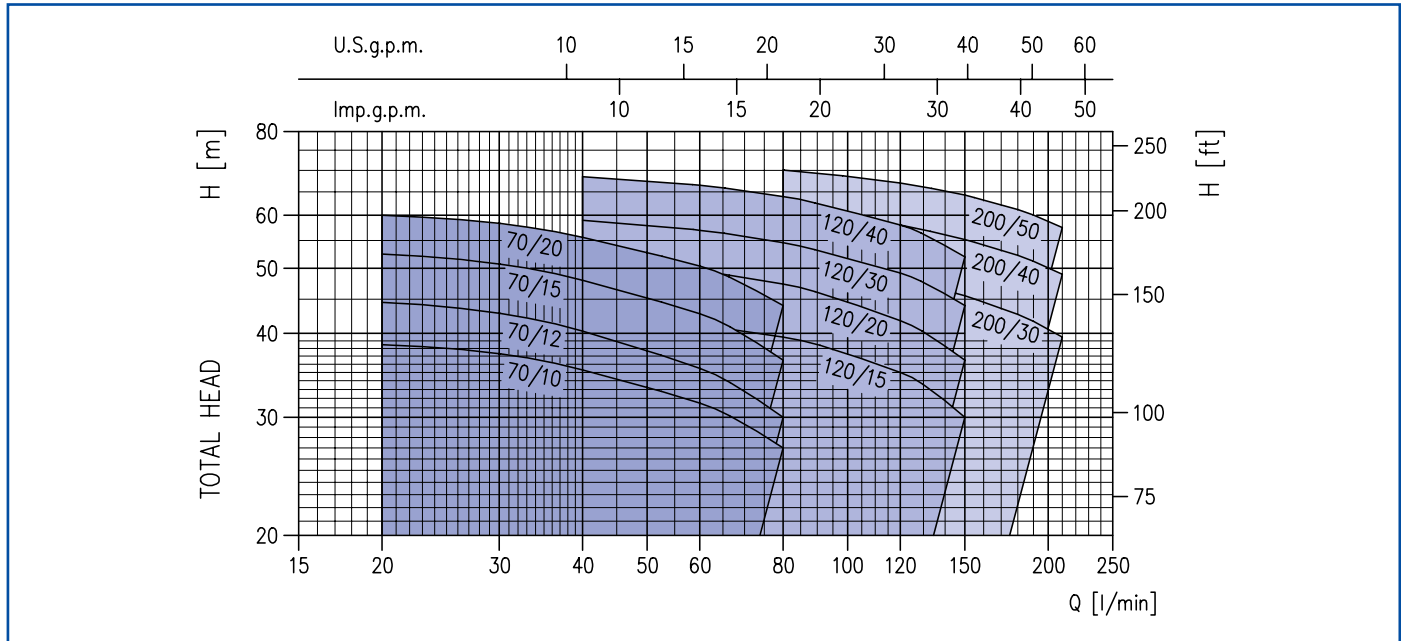
CDX 70

CDX 70/05 (0.37 kW) Diam. Girante / Impeller diameter = 132
 CDX 70/07 (0.55 kW) Diam. Girante / Impeller diameter = 157

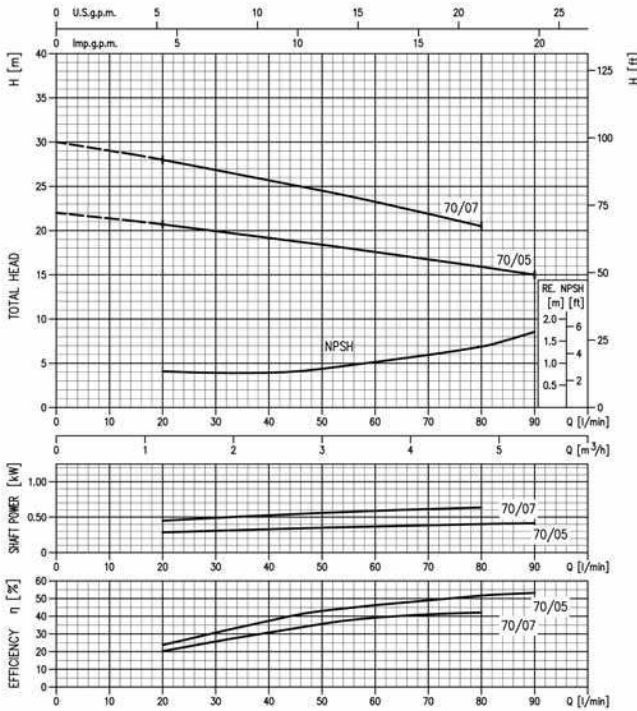

CDX 90

CDX 90/10 (0.75 kW) Diam. Girante / Impeller diameter = 157

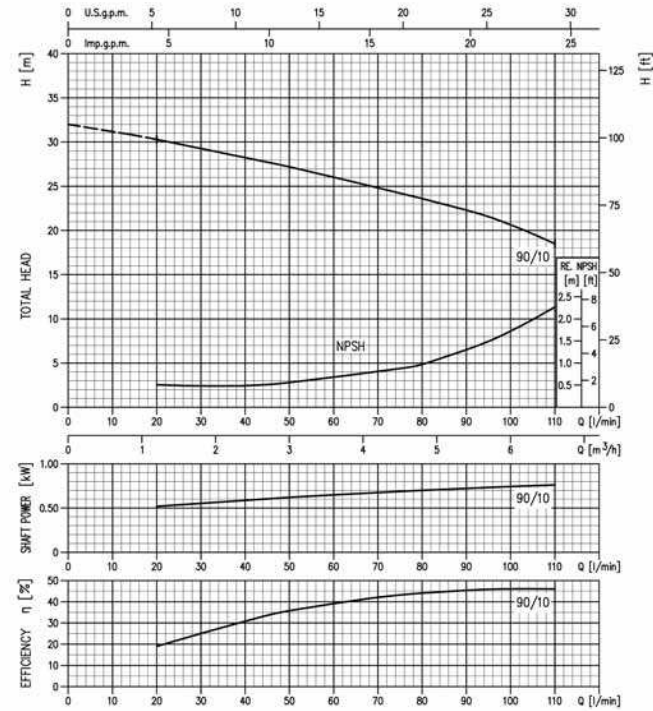

CDX 120

CDX 120/07 (0.55 kW) Diam. Girante / Impeller diameter = 132
 CDX 120/12 (0.90 kW) Diam. Girante / Impeller diameter = 157
 CDX 120/20 (1.50 kW) Diam. Girante / Impeller diameter = 176

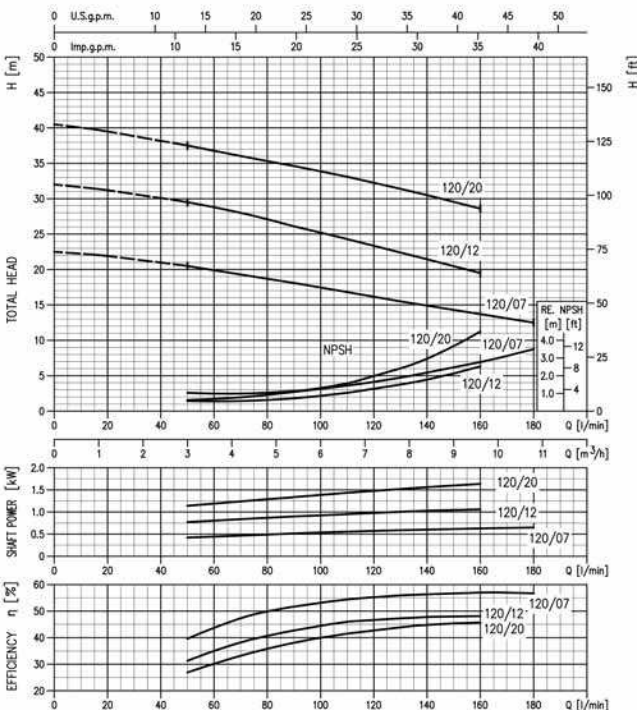

CDX 200

CDX 200/12 (0.9 kW) Diam. Girante / Impeller diameter = 132
 CDX 200/20 (1.5 kW) Diam. Girante / Impeller diameter = 157
 CDX 200/25 (1.8 kW) Diam. Girante / Impeller diameter = 176

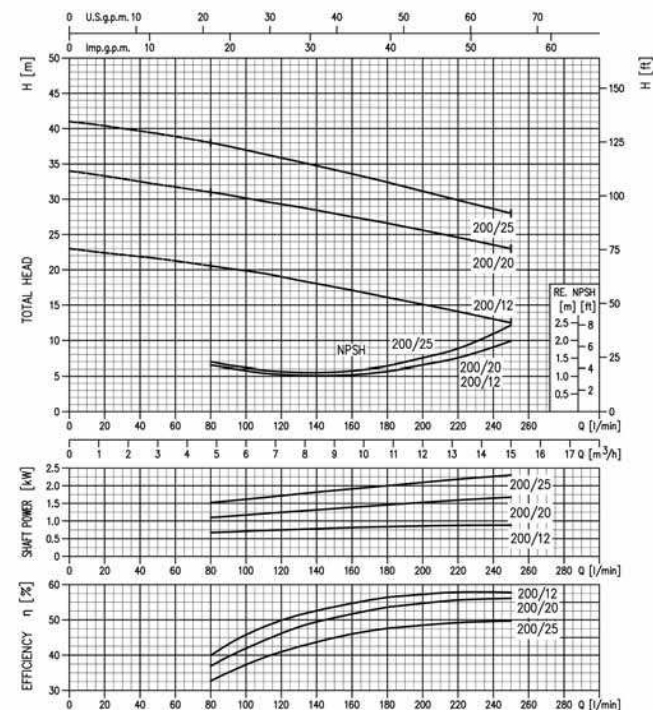

Velocità di rotazione/R.P.M. ≈ 2800 min⁻¹
 Fluido di prova/Test fluid: Acqua pulita/Clean water 20°C
 Tolleranza secondo/Applicable standard: ISO 9906 Allegato/Annex A

CURVE DI PRESTAZIONE / PERFORMANCE CURVES

2CDX

2CDX 70

2CDX 70/10 (0.75 kW) Diam. Girante / Impeller diameter = 132/132
 2CDX 70/12 (0.9 kW) Diam. Girante / Impeller diameter = 153/132
 2CDX 70/15 (1.10 kW) Diam. Girante / Impeller diameter = 153/153
 2CDX 70/20 (1.50 kW) Diam. Girante / Impeller diameter = 153/176

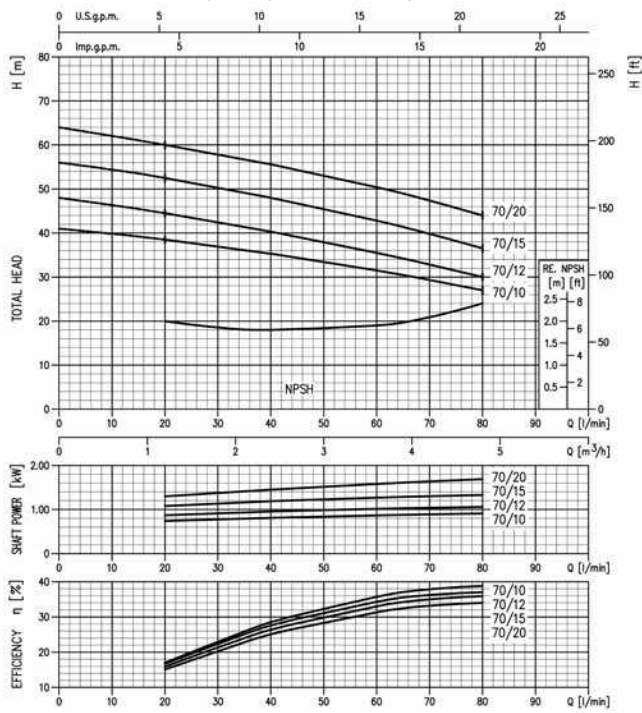

2CDX 120

2CDX 120/15 (1.10 kW) Diam. Girante / Impeller diameter = 132/132
 2CDX 120/20 (1.50 kW) Diam. Girante / Impeller diameter = 157/132
 2CDX 120/30 (2.20 kW) Diam. Girante / Impeller diameter = 157/157
 2CDX 120/40 (3.00 kW) Diam. Girante / Impeller diameter = 176/157

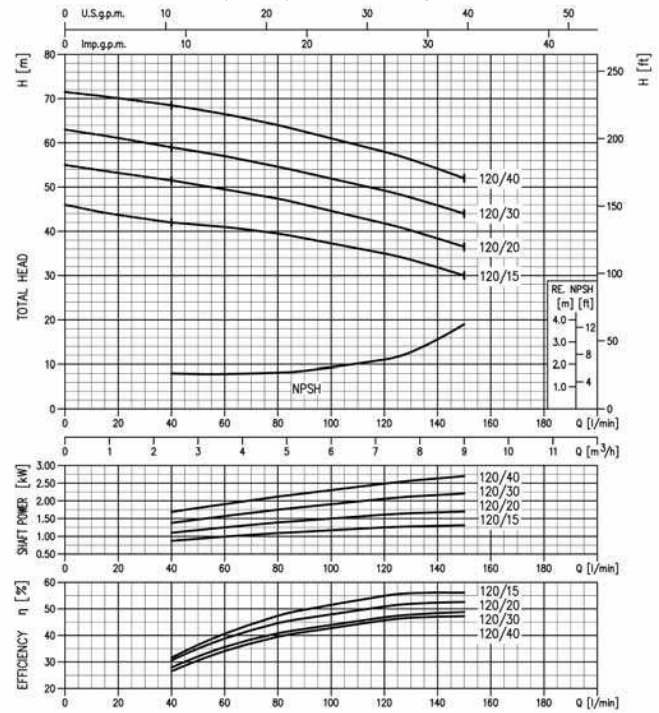

2CDX 200

2CDX 200/30 (2.20 kW) Diam. Girante / Impeller diameter = 157/132
 2CDX 200/40 (3.00 kW) Diam. Girante / Impeller diameter = 157/157
 2CDX 200/50 (3.70 kW) Diam. Girante / Impeller diameter = 176/157

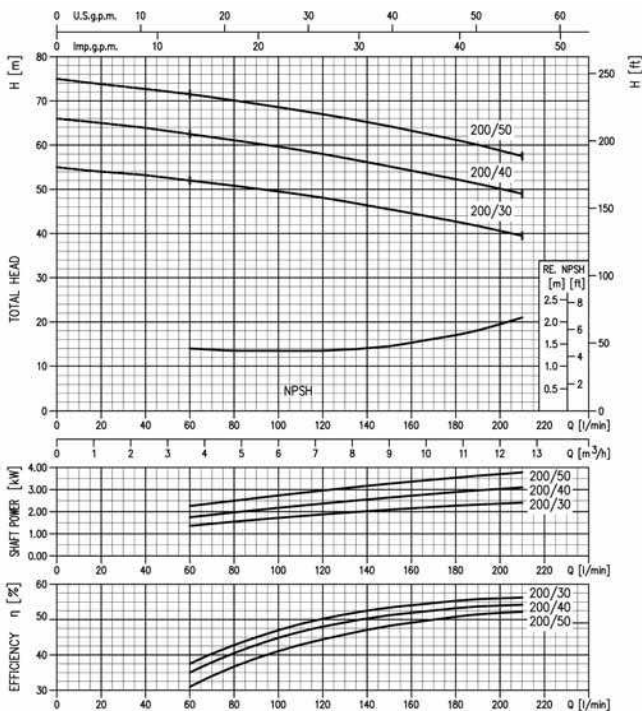

Velocità di rotazione/R.P.M. $\approx 2800 \text{ min}^{-1}$

Fluido di prova/Test fluid: Acqua pulita/Clean water 20°C

Tolleranza secondo/Applicable standard: ISO 9906 Allegato/Annex A

DATI TECNICI / TECHNICAL DATA

CDX

Modelli Type pumps		Potenza Power		Corrente a pieno carico Locked rotor current			Condensatore Capacitor		Potenza ass. Input		Corrente a pieno carico Full load current		
Monofase Single phase	Trifase Three phase	[kW]	[HP]	Monofase Single phase	Trifase Three phase		Monofase Single phase		Monof. Single Phase	Trifase Three Phase	Monof. Single Phase	Trifase Three phase	
230 V 50 Hz	230/400 V 50 Hz			230 V 50 Hz	230 V 50 Hz	400 V 50 Hz	[μF]	Vc[V]				230 V	400 V
CDXM 70/05	CDX 70/05	0.37	0.5	10.1	10.7	6.15	12.5	450	0.7	0.7	3.1	2.4	1.4
CDXM 70/07	CDX 70/07	0.55	0.75	16.1	16.8	9.7	16	450	1	1	4.6	3.5	2
CDXM 90/10	CDX 90/10	0.75	1	22.7	24.1	13.9	20	450	1.2	1.1	5.6	4	2.3
CDXM 120/07	CDX 120/07	0.55	0.75	16.1	16.8	9.7	16	450	1	1	4.6	3.2	1.9
CDXM 120/12	CDX 120/12	0.9	1.2	25	28.2	16.3	31.5	450	1.6	1.6	6.9	5.2	3
CDXM 120/20	CDX 120/20	1.5	2	43	41.6	24	40	450	2.1	2.1	9.3	7	4
CDXM 200/12	CDX 200/12	0.9	1.2	25	28.2	16.3	31.5	450	1.4	1.3	6.3	4.7	2.7
CDXM 200/20	CDX 200/20	1.5	2	43	41.6	24	40	450	2.3	2.1	10.7	7	4
-	CDX 200/25	1.8	2.5	-	46.8	27	-	-	-	2.8	-	8.2	4.8

2CDX

Modelli Type pumps		Potenza Power		Cuscinetti Ball bearing		Condensatore Capacitor		Potenza ass. Input		Corrente a pieno carico Full load current		
Monofase Single phase	Trifase Three phase	[kW]	[HP]	Lato pompa Pump side	Lato ventola Fan side	Monofase Single phase		Monof. Single Phase	Trifase Three Phase	Monof. Single Phase	Trifase Three phase	
230 V 50 Hz	230/400 V 50 Hz					[μF]	Vc[V]				230 V	400 V
2CDXM 70/10	2CDX 70/10	0.75	1	6203 ZZ	6202 ZZ	20	450	1.30	1.18	6.0	4.0	2.3
2CDXM 70/12	2CDX 70/12	0.9	1.2	6203 ZZ	6202 ZZ	31.5	450	1.50	1.50	7.0	5.0	2.9
2CDXM 70/15	2CDX 70/15	1.1	1.5	6204 ZZ	6203 ZZ	35	450	1.80	1.64	8.0	5.6	3.2
2CDXM 70/20	2CDX 70/20	1.5	2	6204 ZZ	6203 ZZ	40	450	2.30	2.20	9.9	7.0	4.0
2CDXM 120/15	2CDX 120/15	1.1	1.5	6204 ZZ	6203 ZZ	35	450	1.80	1.70	8.3	5.6	3.2
2CDXM 120/20	2CDX 120/20	1.5	2	6204 ZZ	6203 ZZ	40	450	2.35	2.20	10.2	7.0	4.0
-	2CDX 120/30	2.2	3	6305 ZZ	6205 ZZ	-	-	-	2.85	-	8.7	5.0
-	2CDX 120/40	3	4	6305 ZZ	6205 ZZ	-	-	-	3.50	-	10.8	6.2
-	2CDX 200/30	2.2	3	6205 ZZ	6205 ZZ	-	-	-	3.05	-	10.4	6.0
-	2CDX 200/40	3	4	6305 ZZ	6205 ZZ	-	-	-	3.85	-	11.4	6.6
-	2CDX 200/50	3.7	5	6206 ZZ	6205 ZZ	-	-	-	4.60	-	15.0	8.7



VISTA IN SEZIONE / SECTIONAL VIEW

CDX

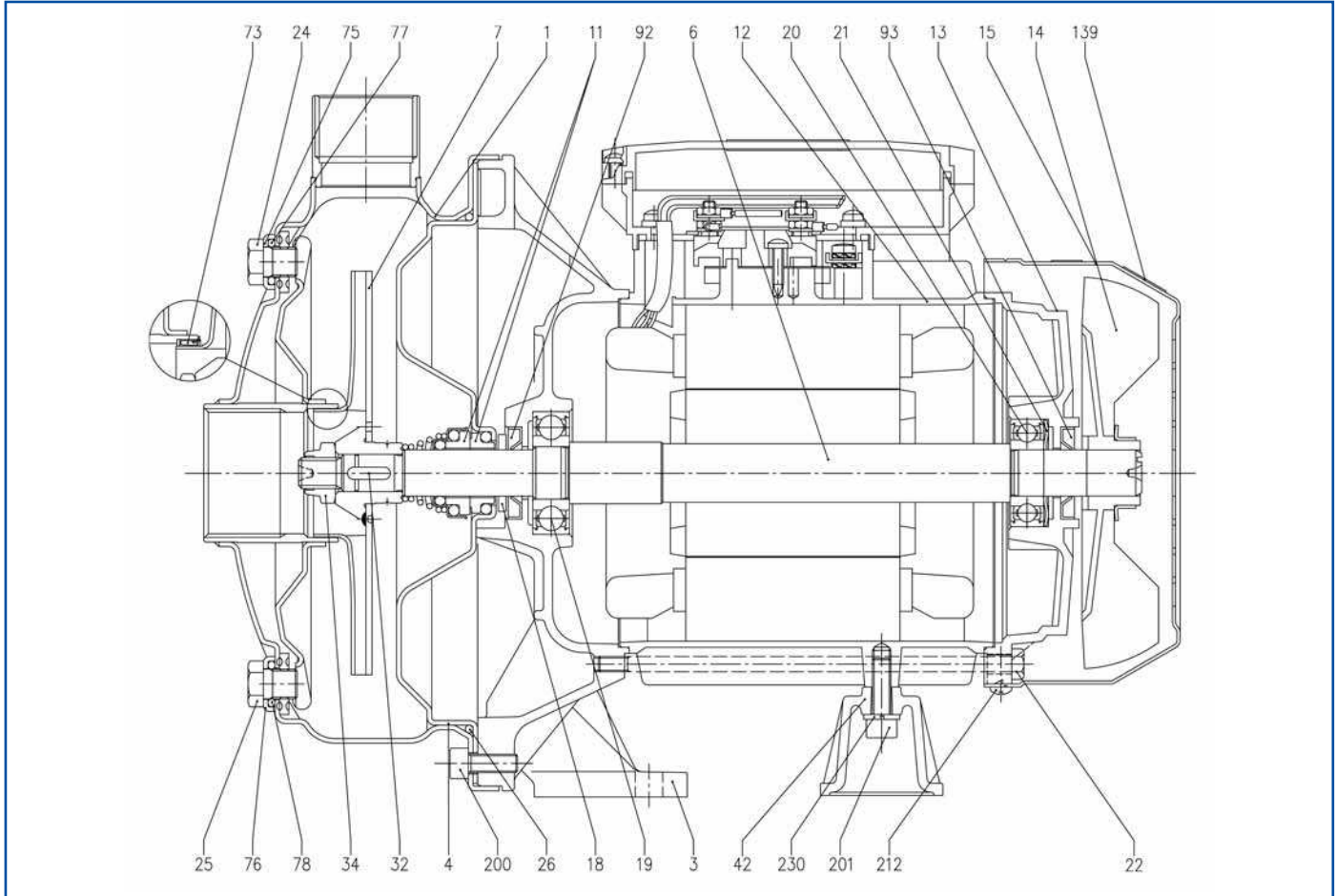

POS. N°	DESCRIZIONE PART NAME	MATERIALE MATERIAL	Q.TA Q.TY	POS. N°	DESCRIZIONE PART NAME	MATERIALE MATERIAL	Q.TA Q.TY
1	Corpo pompa / Casing	AISI 304	1	24	Tappo / Priming plug	AISI 303	1
3	Supporto motore / Motor bracket	Alluminio / Aluminium	1	25	Tappo / Drain plug	AISI 303	1
4	Disco P/Tenuta / Casing cover	AISI 304	1	26	O-ring [3]	NBR	1
6	Albero rotore / Shaft with rotor	AISI 303 (Parte in contatto con il liquido) / (Part in contact with liquid)	1	32	Linguetta / Key	AISI 304	1
7	Girante / Impeller	AISI 304	1	34	Dado Aut. / Impeller nut	AISI 304	1
11	Ten. meccanica / Mechanical seal [3]	Ceramica/Carbone/NBR Ceramic/Carbon/NBR	1	42	Piedino / Motor support	Alluminio / Aluminium	1
12	Cassa motore / Motor frame with stator	-	1	52	Morsettiera / Terminal box [1]	Polipropilene / Polypropilene	1
13	Coperchio motore / Motor cover	Alluminio / Aluminium	1	53	Coprimorsettiera / Terminal box cover [1]	Polipropilene / Polypropilene	1
14	Ventola / Fan	Polipropilene / Polypropilene	1	56	Guarniz. coprim. / Box gasket	NBR	1
15	Copriventola / Fan cover	Fe P04 Zincato / Zinked	1	73	Anello rasam. / Casing ring [4]	AISI 304	1
16	Morsettiera / Terminal board	-	1	75	Rondella / Washer	AISI 304	1
17	Coprimorsettiera / Terminal box cover [2]	Alluminio / Aluminium	1	76	Rondella / Washer	AISI 304	1
18	Rondella paraspruzzi / Splash ring	NBR	1	77	O-ring [3]	NBR	1
19	Cuscinetto lato pompa / Pump side ball bearing	-	1	78	O-ring [3]	NBR	1
20	Cuscinetto lato ventola / Fan side ball bearing	-	1	90	Guarn. sc/porta morsett. / Cover gasket [1]	NBR	1
21	Anello compensatore / Adjusting ring	Acciaio / Steel C70	1	92	Anello ten. / Lip seal	-	1
22	Tirante / Tie rod	Zincato / Zinked Fe 42	4	93	Anello ten. / Lip seal	-	1
23	Condensatore / Capacitor [1]	-	1	110	Protettore / Protector [1]	-	1
				200	Vite / Screw	Acciaio / Stainless steel A2 UNI7323	8

[1] Solo per versione monofase / Only for single phase

[2] Solo per versione trifase / Only for three phase

[3] FPM per/for CDXH e/and CDXHS

[4] NBR per/for. CDX 70/05, 70/07, 90/10

FPM per/for. CDXH 70/05, 70/07, 90/10 e/and CDXHS 70/05, 70/07, 90/10

DATI / TECHNICAL DATA

2CDX

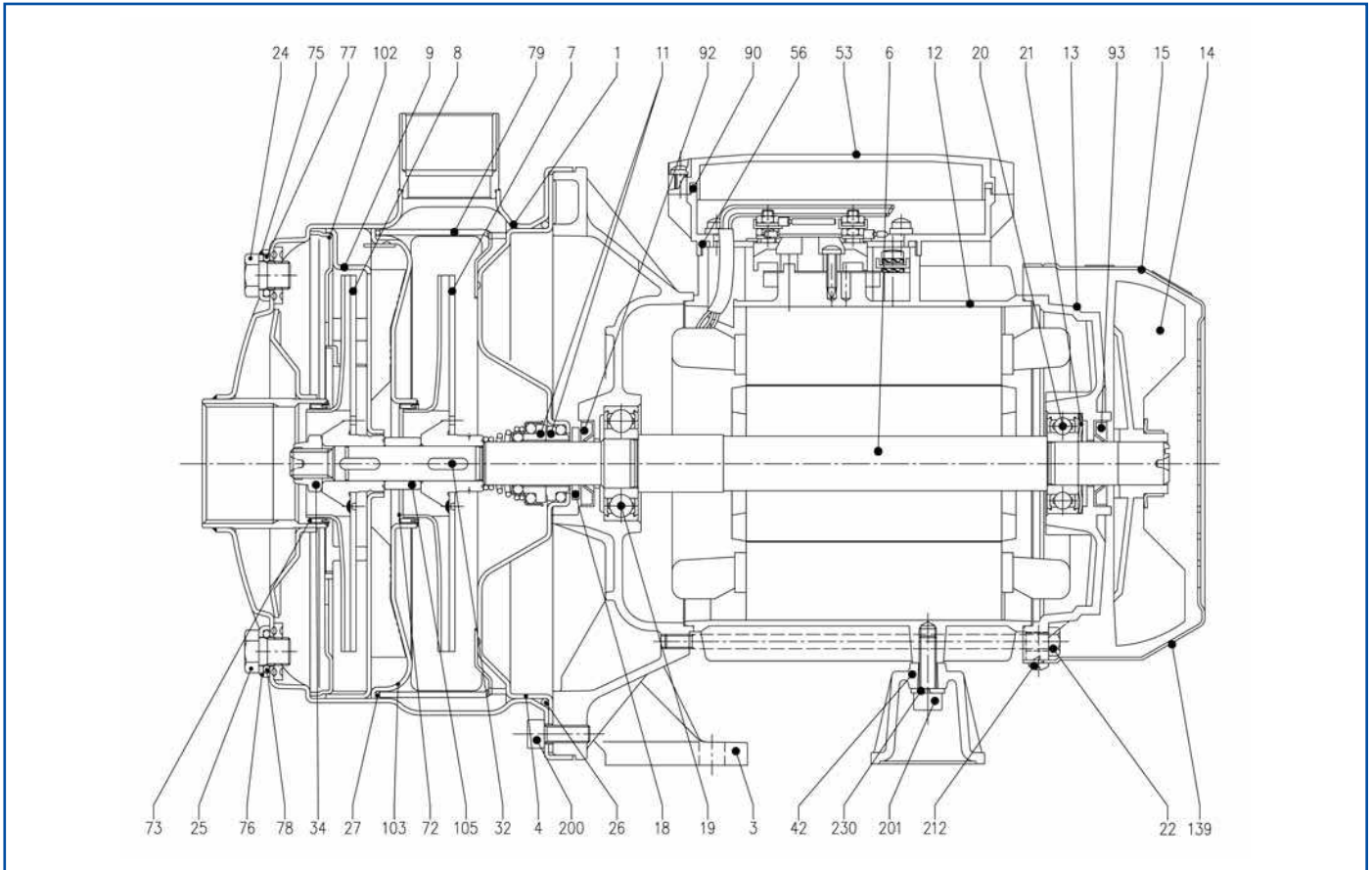

POS. N°	DESCRIZIONE PART NAME	MATERIALE MATERIAL	Q.TA Q.TY	POS. N°	DESCRIZIONE PART NAME	MATERIALE MATERIAL	Q.TA Q.TY
1	Corpo pompa / Casing	AISI 304	1	24	Tappo / Priming plug	AISI 303	1
3	Supporto motore / Motor bracket	Alluminio / Aluminium (fino a / up to 1.5 kW incluso / included)	1	25	Tappo / Drain plug	AISI 303	1
		Ghisa / Cast iron (per / for 2.2 kW e oltre / and above)		26	O-ring [3]	NBR	1
				27	O-ring [3]	NBR	1
				32	Linguetta / Key	AISI 304	1
4	Disco P/Tenuta / Casing cover	AISI 304	1	34	Dado Aut. / Impeller nut	AISI 304	1
6	Albero rotore / Shaft with rotor	AISI 304 (Parte in contatto con il liquido) / (Part in contact with liquid)	1	42	Piedino / Motor support	Alluminio / Aluminium	1
7	Girante / Impeller	AISI 304	1	52	Morsetiera / Terminal box [1]	Polipropilene / Polypropilene	1
8	Girante / Impeller	AISI 304	1	53	Coprimorsetiera / Terminal box cover [1]	Polipropilene / Polypropilene	1
9	Diffusore / Diffuser	AISI 304	1	56	Guarniz. coprim. / Box gasket	NBR	1
11	Ten. meccanica / Mechanical seal [3]	Ceramica/Carbone/NBR Ceramic/Carbon/NBR	1	72	Anello rasam. / Casing ring [3]	NBR	1
				73	Anello rasam. / Casing ring [3]	NBR	1
				75	Rondella / Washer	AISI 304	1
12	Cassa motore / Motor frame with stator	-	1	76	Rondella / Washer	AISI 304	1
13	Coperchio motore / Motor cover	Alluminio / Aluminium	1	77	O-ring [3]	NBR	1
14	Ventola / Fan	Polipropilene / Polypropilene	1	78	O-ring [3]	NBR	1
15	Copriventola / Fan cover	Fe P04 Zincato / Zinked	1	79	Distanziale diffusore / Space diffuser	AISI 304	1
16	Morsetiera / Terminal box	-	1	90	Guarn. sc/porta morsett. / Cover gasket [1]	NBR	1
17	Coprimorsetiera / Terminal box cover [2]	Alluminio / Aluminium	1	92	Anello ten. / Lip seal	-	1
18	Rondella paraspruzzi / Splash ring	NBR	1	93	Anello ten. / Lip seal	-	1
19	Cuscinetto lato pompa / Pump side ball bearing	-	1	102	Coperchio diffusore / Suction cover	AISI 304	1
20	Cuscinetto lato ventola / Fan side ball bearing	-	1	103	Coperchio convogl. / Conveyor cover	AISI 304	1
21	Anello compensatore / Adjusting ring	Acciaio / Steel C70	1	105	Dist. gir. / Sleeve	AISI 304	1
22	Tirante / Tie rod	Zincato / Zinked Fe 42	4	110	Protettore / Protector [1]	-	1
23	Condensatore / Capacitor [1]	-	1	200	Vite / Screw	Acciaio / Stainless steel A2 UNI7323	8

[1] Solo per versione monofase / Only for single phase

[2] Solo per versione trifase / Only for three phase

[3] FPM per/for 2CDXH e/and 2CDXHS



DIMENSIONI / DIMENSIONS

CDX

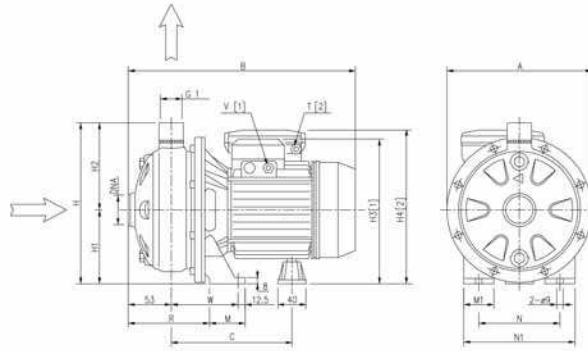

Modelli Type pumps	Dimensioni / Dimensions [mm]																Peso / Weight [Kg]	
	A	B	C	H	H1	H2	H3	H4	M	M1	N	N1	R	T	W	DNA	Monof. Single phase	Trifase Three phase
CDXM-CDX																		
70/05	208	318	178	229.5	106	123.5	209	215	50	38	120	160	108	PG11	92.5	G1 1/4	9.1	9.1
70/07	208	318	178	229.5	106	123.5	209	215	50	38	120	160	108	PG11	92.5	G1 1/4	10.4	10.4
90/10	208	318	178	229.5	106	123.5	209	215	50	38	120	160	108	PG11	92.5	G1 1/4	11.9	11.9
120/07	208	318	178	229.5	106	123.5	209	215	50	38	120	160	108	PG11	92.5	G1 1/4	10.4	10.4
120/12	208	318	178	229.5	106	123.5	209	215	50	38	120	160	108	PG13.5	92.5	G1 1/4	12.5	12.5
120/20	232	345	199	250	118	132	235	253	55	40	140	180	105.5	PG13.5	95	G1 1/4	17.2	16.2
200/12	208	318	178	229.5	106	123.5	209	215	50	38	120	160	108	PG13.5	92.5	G1 1/2	16.3	11.4
200/20	208	345	199	229.5	106	123.5	223	240	55	40	140	180	105.5	PG13.5	95	G1 1/2	15.3	14.2
200/25	232	345	199	250	118	132	235	-	55	40	140	180	105.5	-	95	G1 1/2	-	17

[1] Solo per trifase / Only for three phase

[2] Solo per monofase / Only for single phase

2CDX

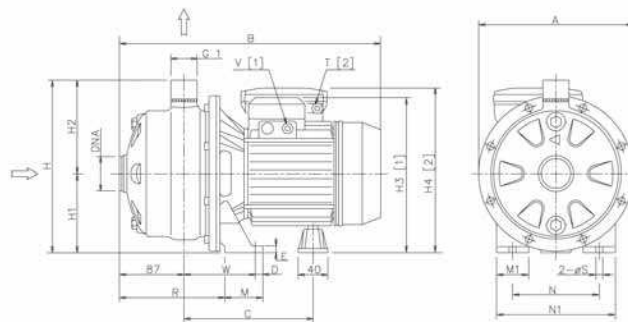

Modelli Type pumps	Dimensioni / Dimensions [mm]																			Peso / Weight [Kg]		
	A	B	C	D	E	H	H1	H2	H3	H4	M	M1	N	N1	R	T	V	W	S	DNA	Monof. Single phase	Trifase Three phase
2CDXM-2CDX																						
70/10	208	355	169	12.5	8	229	106	123	206	210	50	38	120	160	142.5	PG 11	PG 11	93	9	G1 1/4	13.5	13.3
70/12	208	355	169	12.5	8	229	106	123	206	231	50	38	120	160	142.5	PG 13.5	PG 11	93	9	G1 1/4	14.2	13.8
70/15	232	385	199	12.5	8	250	118	132	238	251	55	40	140	180	140	PG 13.5	PG 11	95	9	G1 1/4	17.4	16.4
70/20	232	385	199	12.5	8	250	118	132	238	251	55	40	140	180	140	PG 13.5	PG 11	95	9	G1 1/4	18.6	18.2
120/15	208	380	199	12.5	8	229	106	123	226	239	55	40	140	180	140	PG 13.5	PG 11	95	9	G1 1/4	15.5	15.3
120/20	208	380	199	12.5	8	229	106	123	226	239	55	40	140	180	140	PG 13.5	PG 11	95	9	G1 1/4	18	16.9
120/30	232	393	210	12.5	8	250	118	132	242	-	65	40	140	180	144	-	PG 13.5	109	9	G1 1/4	-	23.2
120/40	232	394	210	12.5	8	250	118	132	242	-	65	40	140	180	144	-	PG 13.5	109	9	G1 1/4	-	26.4
200/30	208	394	210	12.5	8	229	106	123	230	-	65	40	140	180	144	-	PG 13.5	109	9	G1 1/2	-	25
200/40	232	394	210	12.5	8	250	118	132	242	-	65	40	140	180	144	-	PG 13.5	109	9	G1 1/2	-	25
200/50	232	450	236	16	13	250	118	132	255	-	68	50	160	210	144	-	PG 16	109	12	G1 1/2	-	32.7

[1] Solo per trifase / Only for three phase

[2] Solo per monofase / Only for single phase

TENUTA MECCANICA / CONSTRUCTIONS

CDX

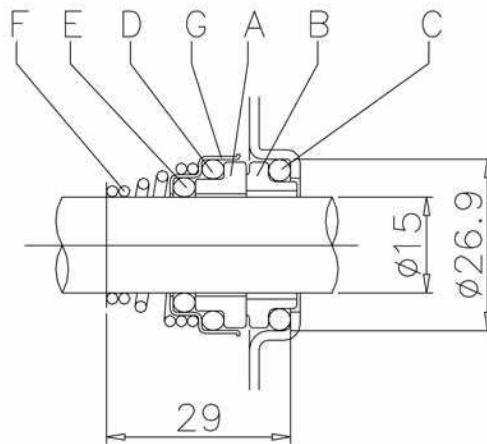

Ref	Descrizione / Part name	Vers. standard / Standard version (CDX)	Materiale / Material	
			(CDXH)	Optional (CDXHS)
A	Parte rotante / Rotary seal ring	Ceramica / Ceramic	Ceramica / Ceramic	Carburo di silicio / Silicon carbide
B	Parte fissa / Stationary seal ring	Carbone / Carbon graphite	Carbone / Carbon graphite	Carburo di silicio / Silicon carbide
C	O Ring	NBR	FPM	FPM
D	O Ring	NBR	FPM	FPM
E	O Ring	NBR	FPM	FPM
F	Molla / Self driving spring	AISI 316	AISI 316	AISI 316
G	Armatura / Frame	AISI 304	AISI 304	AISI 316

2CDX

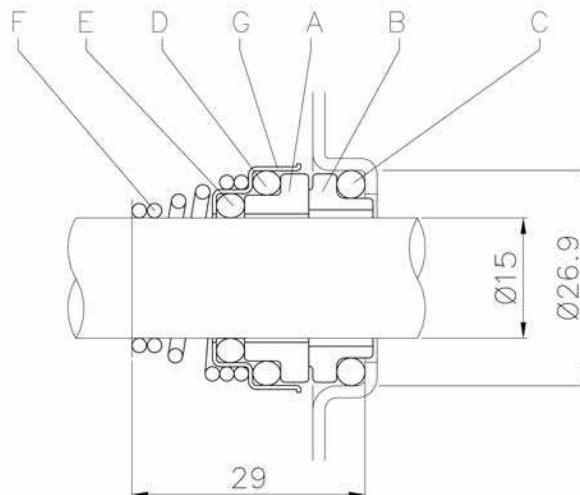

Ref	Descrizione / Part name	Vers. standard / Standard version (2CDX)	Materiale / Material	
			(2CDXH)	Optional (2CDXHS)
A	Parte rotante / Rotary seal ring	Ceramica / Ceramic	Ceramica / Ceramic	Carburo di silicio / Silicon carbide
B	Parte fissa / Stationary seal ring	Carbone / Carbon graphite	Carbone / Carbon graphite	Carburo di silicio / Silicon carbide
C	O Ring	NBR	FPM	FPM
D	O Ring	NBR	FPM	FPM
E	O Ring	NBR	FPM	FPM
F	Molla / Self driving spring	AISI 316	AISI 316	AISI 316
G	Armatura / Frame	AISI 304	AISI 304	AISI 316



Filiali EBARA in Italia Italian Branches

EBARA BARI

Via Po, 3
70026 MODUGNO (BA)
Tel. 080/5320531 - Fax: 080/5320478

EBARA CAGLIARI

Via del Fangario, 29 - 09122 CAGLIARI
Tel. 070/274281 - Fax: 070/253643

EBARA FIRENZE

Via del Pesco, 15 Loc. La Querce
59100 PRATO
Tel. 0574/514175 - Fax: 0574/700126

EBARA MILANO

Via Magenta, 77 - 20017 RHO (MI)
Tel. 02/93507358/59 - Fax: 02/93507361

EBARA PALERMO

Via Don L. Sturzo, 181/183
ZONA INDUSTRIALE - 90044 CARINI (PA)
Tel. 091/8680840 - Fax: 091/8669790

EBARA PESCARA

Via Aterno, 61 - Z. Ind.le e Com.le
66100 SAMBUCETO - S.GIOVANNI TEATINO (CH)
Tel. 085/4465145 - Fax: 085/4465171

EBARA ROMA

Via E. Ferrari, 105
00043 CIAMPINO (RM)
Tel. 06/79341516 - Fax: 06/79341628

Agenzie Agencies

NAPOLI

DIVIERRE
Tel. 081 2583654 - Fax 081 2508617

PADOVA

NEGRISOLO GIANNI
Tel. 049 9900296 - Fax 049 9903539

PORDENONE

FOR-TEC
Tel. 0434 957878 - Fax 0434 560343

GENOVA

VOLPARA FABRIZIO
Tel. 010 7727084 - Fax 010 7729018



EBARA PUMPS EUROPE S.p.A.

Via Pacinotti, 32
36040 BRENDOLO (VI) ITALY
Phone: +39 0444.706.811 - Fax: +39 0444.706.950
Plants: Cles, Brendola
e-mail: marketing@ebaraeurope.com
www.ebaraeurope.com

EBARA PUMPS UK LIMITED

Unit 7 - Zodiac Business Park
High Road - Cowley
Uxbridge
Middlesex - UB8 2GU, United Kingdom
Phone: +44 1895.439.027
Fax: +44 1895.439.028

EBARA ESPAÑA BOMBAS S.A.

C/Cormoranes 6y8. Polígono La Estación,
28320 PINTO (MADRID), Spain
Phone: +34 916.923.630
Fax: +34 916.910.818

EBARA FRANCE

Maille Nord 2
6/10 Avenue Montaigne
93160 NOISY LE GRAND, France
Phone: +33 155.851.616
Fax: +33 155.851.639

EBARA PUMPEN

Philipp-Reis - Str. 15
63128 DIETZENBACH, Germany
Phone: +49 6074.827.90
Fax: +49 6074.827.942

EBARA Pompy Polska Sp. z o.o.

ul. Minska 63
03-828 Warszawa, Poland
Phone: +48 22.330.81.18
Fax: +48 22.330.81.19