

**Bombas centrífugas multicelulares verticales, monobloc, completamente silenciosas. Suministradas con bridas. Contrabridas opcionales.**

**Materiales:**

Tubo envolvente, impulsores y soporte sello en acero inoxidable AISI 304.  
Eje motor en acero inoxidable AISI 303.  
Difusores en tecnopolímero.  
Bridas, soportes aspiración e impulsión en acero inoxidable AISI 304.  
Cierre mecánico en grafito/carburo de silicio.  
Carcasa motor en aluminio.  
Juntas en NBR/EPDM.

**Motor:**

Asincrónico, dos polos.  
Protección IP 55.  
Aislamiento clase F.  
Servicio continuo.

**Quiet running monobloc vertical multi-stage centrifugal pumps. Supplied with flanges. Counterflanges in option.**

**Materials:**

Outer casing, impellers and seal mounting in stainless steel AISI 304.  
Motor shaft in stainless steel AISI 303.  
Diffusers in tecnopolimer.  
Flanges, suction and discharge mountings in stainless steel AISI 304.  
Mechanical seal in graphite/silicon carbide.  
Motor housing in aluminium.  
O'rings in NBR/EPDM.

**Motor:**

Asynchronous, two poles.  
IP 55 protection.  
Class F insulation.  
Continuous operation.

**Aplicaciones:**

Riego por aspersión y conjuntos hidroneumáticos de presión en instalaciones domésticas.

**Applications:**

Spray irrigation systems and hydropneumatic sets in domestic installations.



# Multinox 55

	A2	B	C	D	E	F2	G2	H2	J	K	DN	M2	ØN	(*)	Kg
<b>Multinox 55 3</b>	300	180	255	130	215	125	90	586	156	200	50	M16x60	13	IEC 80	32
<b>Multinox 55 3M</b>	300	180	255	130	215	125	90	628	176	250	50	M16x60	13	IEC 90	36
<b>Multinox 55 4</b>	300	180	255	130	215	125	90	668	176	215	50	M16x60	13	IEC 90	37
<b>Multinox 55 5</b>	300	180	255	130	215	125	90	737	194	235	50	M16x60	13	IEC 100	43
<b>Multinox 55 6</b>	300	180	255	130	215	125	90	776	194	235	50	M16x60	13	IEC 100	48
<b>Multinox 55 7</b>	300	180	255	130	215	125	90	815	194	235	50	M16x60	13	IEC 100	52
<b>Multinox 55 8</b>	300	180	255	130	215	125	90	872	194	235	50	M16x60	13	IEC 112	63
<b>Multinox 55 9</b>	300	180	255	130	215	125	90	911	218	255	50	M16x60	13	IEC 112	64

(\*) Motor / Motor

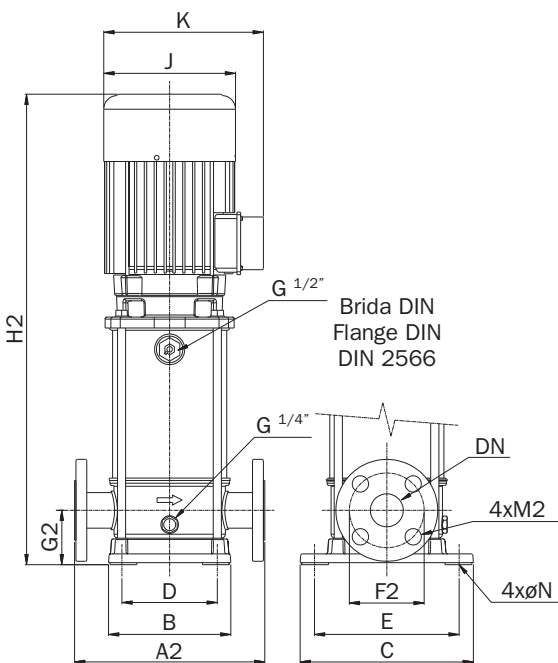

**Curvas de funcionamiento a 2900 r.p.m.**  
**Performance curves at 2900 r.p.m.**

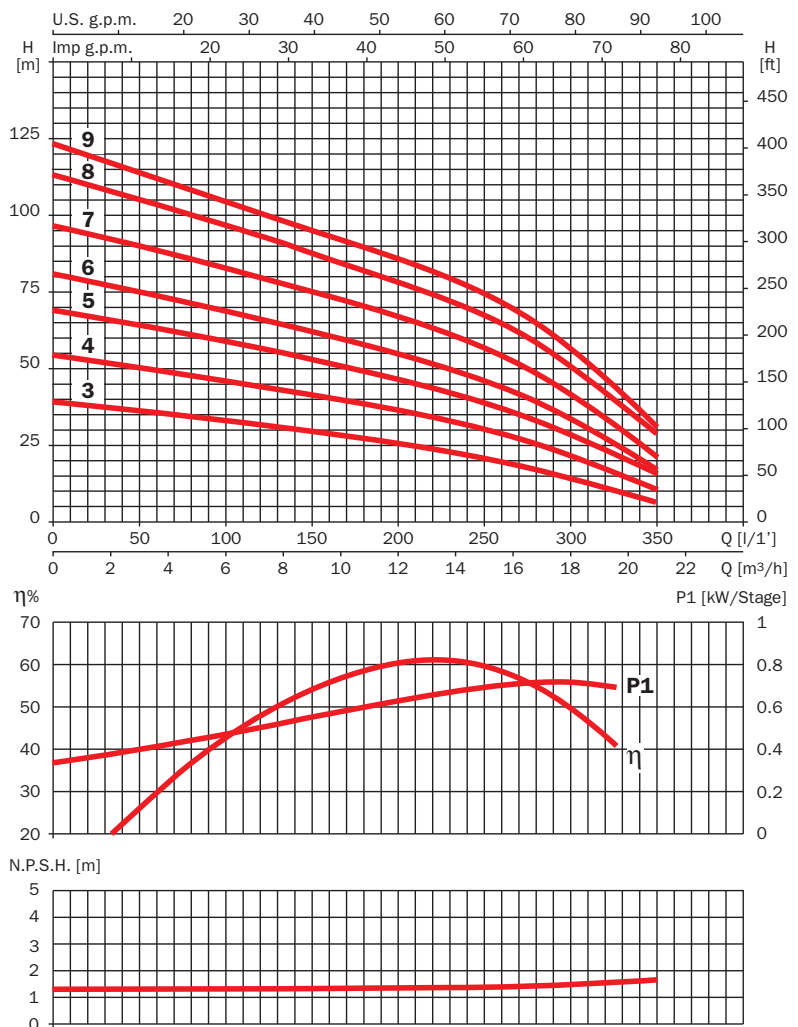

230 V 50 Hz	230/400 V 50 Hz	A			P1 (kW)		kW	HP	µF	l/1'	20	50	100	150	200	250	300	350
		1~ 230 V	230 V	3~ 400 V	1~	3~												
<b>Multinox 55 3M</b>	<b>Multinox 55 3</b>	9.8	7	4.1	2.2	2.2	1.5	2	40		38	36	33	30	25	20	14	6
	<b>Multinox 55 4</b>		8	4.6		2.7	2.2	3			53	50	46	41	36	30	21	10
	<b>Multinox 55 5</b>		11.3	6.5		3.6	3	4			67	64	59	53	46	39	23	15
	<b>Multinox 55 6</b>		12.5	7.2		4.1	3	4			79	75	69	62	55	46	28	17
	<b>Multinox 55 7</b>		15.4	8.9		4.9	4	5.5			94	90	82	75	66	56	41	21
	<b>Multinox 55 8</b>		17	9.8		5.8	5.5	7.5			110	105	96	82	78	67	50	28
	<b>Multinox 55 9</b>		18.2	10.5		6.2	5.5	7.5			120	114	104	95	85	74	56	31

# Multinox 35

	A1	A2	B	C	D	E	F1	F2	G1	G2	H1	H2	J	K	DN	M1	M2	ØN	(*)	Kg
<b>Multinox 35 4</b>	200	-	180	255	130	215	100	-	80	-	556	-	156	200	40	M12x30	-	13	IEC 80	29,3
<b>Multinox 35 4M</b>	200	-	180	255	130	215	100	-	80	-	598	-	176	250	40	M12x30	-	13	IEC 90	33,2
<b>Multinox 35 5</b>	200	-	180	255	130	215	100	-	80	-	623	-	176	215	40	M12x30	-	13	IEC 90	33,6
<b>Multinox 35 6</b>	200	-	180	255	130	215	100	-	80	-	647	-	176	215	40	M12x30	-	13	IEC 90	36,4
<b>Multinox 35 7</b>	-	280	180	255	130	215	-	110	-	80	-	672	176	215	40	-	M16x60	13	IEC 90	37,2
<b>Multinox 35 8</b>	-	280	180	255	130	215	-	110	-	80	-	726	194	235	40	-	M16x60	13	IEC 100	41,8
<b>Multinox 35 9</b>	-	280	180	255	130	215	-	110	-	80	-	751	194	235	40	-	M16x60	13	IEC 100	45,4
<b>Multinox 35 10</b>	-	280	180	255	130	215	-	110	-	80	-	775	194	235	40	-	M16x60	13	IEC 100	46,2

(\*) Motor / Motor

### Curvas de funcionamiento a 2900 r.p.m. Performance curves at 2900 r.p.m.

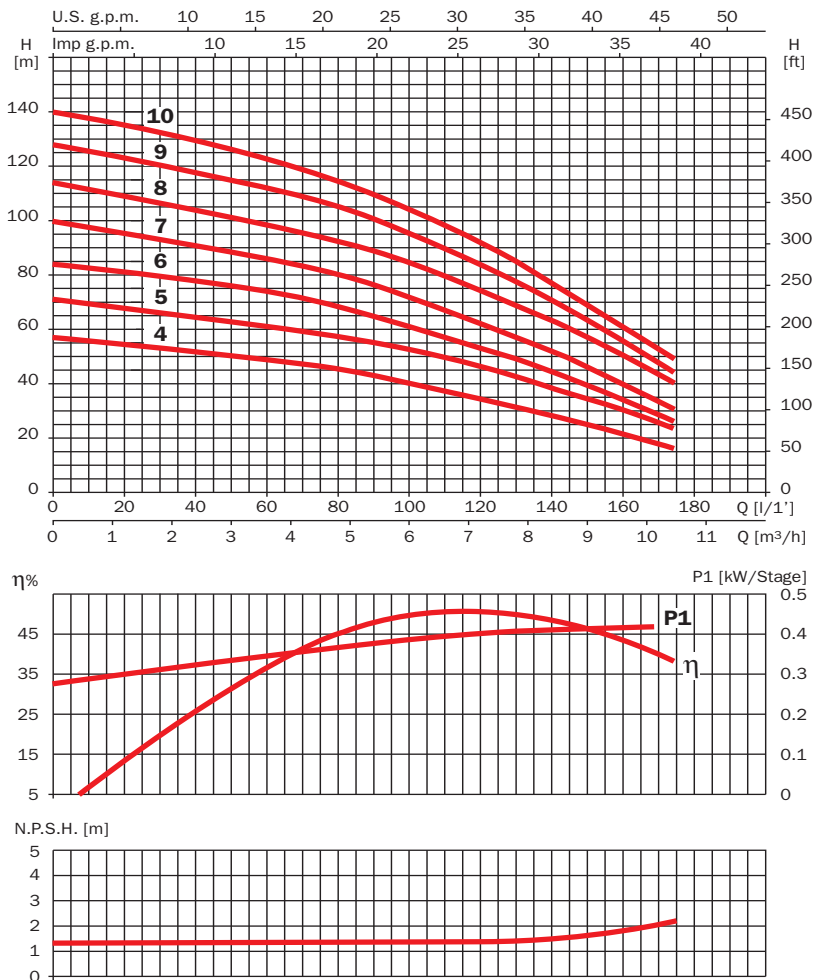
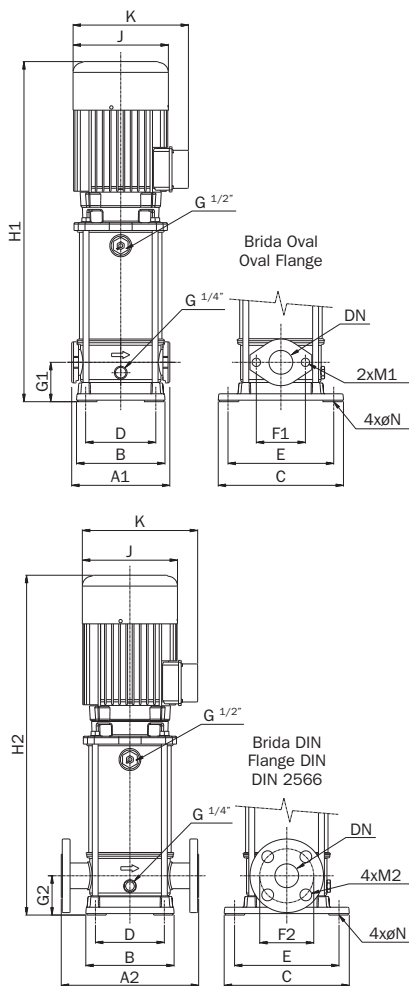

230 V 50 Hz	230/400 V 50 Hz	A			P1 (kW)		kW	HP	µF	l/1'	10	30	50	80	100	130	150	170
		1~ 230 V	230 V	3~ 400 V	1~	3~												
<b>Multinox 35 4M</b>	<b>Multinox 35 4</b>	9	3.7	3.7	2	1.8	1.5	2	40		56	54	50	45	40	31	25	17
	<b>Multinox 35 5</b>		8	4.6		2.4	2	3			70	66	63	57	53	43	35	25
	<b>Multinox 35 6</b>		8	4.6		2.7	2	3			83	80	76	68	61	49	40	28
	<b>Multinox 35 7</b>		8.6	5		3	2	3			97	93	88	80	72	57	46	33
	<b>Multinox 35 8</b>		11.2	6.5		3.8	3	4			112	106	101	92	85	69	57	43
	<b>Multinox 35 9</b>		14.5	8.4		4.3	4	5.5			125	120	115	105	95	77	63	47
	<b>Multinox 35 10</b>		15.4	8.9		4.6	4	5.5			138	132	126	115	104	85	69	53

# Multinox 45

	A1	A2	B	C	D	E	F1	F2	G1	G2	H1	H2	J	K	DN	M1	M2	ØN	(*)	Kg
<b>Multinox 45 3</b>	200	-	180	255	130	215	100	-	80	-	550	-	156	200	40	M12x35	-	13	IEC 80	29
<b>Multinox 45 3M</b>	200	-	180	255	130	215	100	-	80	-	550	-	156	230	40	M12x35	-	13	IEC 80	29
<b>Multinox 45 4</b>	200	-	180	255	130	215	100	-	80	-	623	-	176	215	40	M12x35	-	13	IEC 90	33,4
<b>Multinox 45 4M</b>	200	-	180	255	130	215	100	-	80	-	623	-	176	250	40	M12x35	-	13	IEC 90	33,4
<b>Multinox 45 5</b>	200	-	180	255	130	215	100	-	80	-	654	-	176	215	40	M12x35	-	13	IEC 90	34,6
<b>Multinox 45 6</b>	200	-	180	255	130	215	100	-	80	-	715	-	194	235	40	M12x35	-	13	IEC 100	39,2
<b>Multinox 45 7</b>	-	280	180	255	130	215	-	110	-	80	-	746	194	235	40	-	M16x50	13	IEC 100	45,3
<b>Multinox 45 8</b>	-	280	180	255	130	215	-	110	-	80	-	793	218	255	40	-	M16x50	13	IEC 112	57,5
<b>Multinox 45 9</b>	-	280	180	255	130	215	-	110	-	80	-	824	218	255	40	-	M16x50	13	IEC 112	58,5
<b>Multinox 45 10</b>	-	280	180	255	130	215	-	110	-	80	-	855	218	255	40	-	M16x50	13	IEC 112	60,5

(\*) Motor / Motor

Curvas de funcionamiento a 2900 r.p.m.  
Performance curves at 2900 r.p.m.

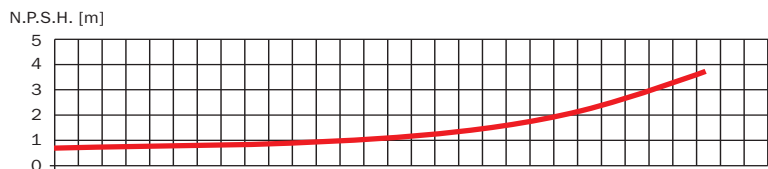
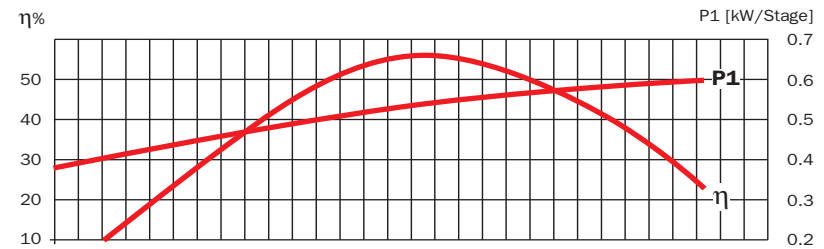
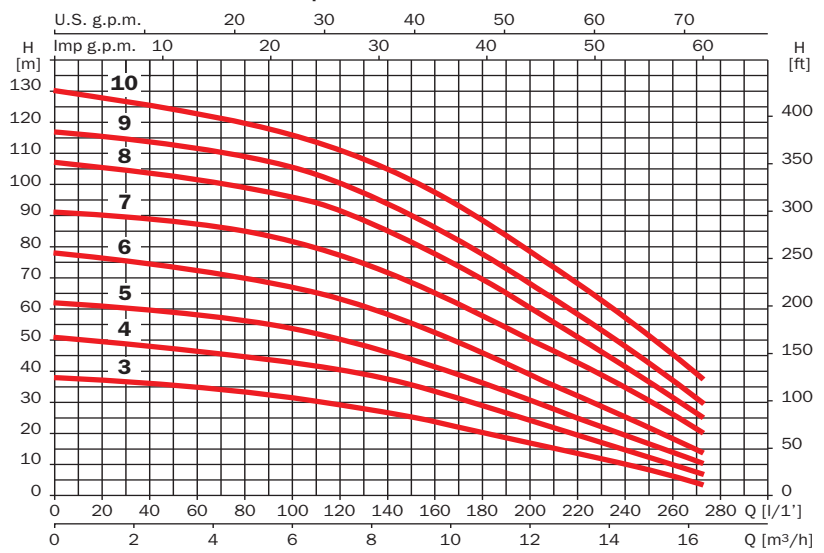
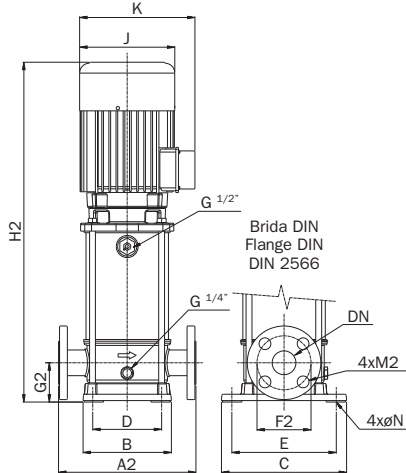
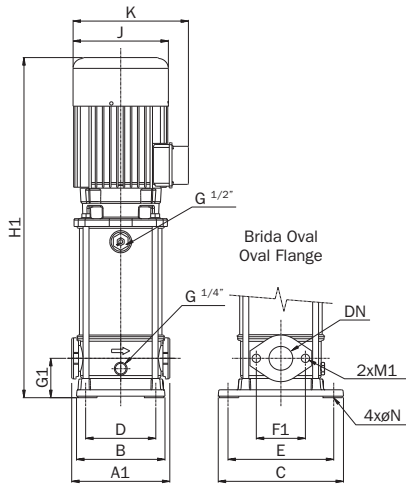

230 V 50 Hz	230/400 V 50 Hz	A			P1 (kW)		kW	HP	µF	l/1' m³/h	10	40	80	120	160	200	240	270
		1~ 230 V	230 V	3~ 400 V	1~	3~												
<b>Multinox 45 3M</b>	<b>Multinox 45 3</b>	8.4	6.4	3.7	1.9	1.9	1.1	1.5	25		38	36	33	29	24	17	10	4
<b>Multinox 45 4M</b>	<b>Multinox 45 4</b>	10.5	8.1	4.1	2.4	2.4	1.5	2	40		50	48	45	40	33	24	15	7
	<b>Multinox 45 5</b>		8.1	4.1		2.8	2	3			62	60	56	50	41	30	20	11
	<b>Multinox 45 6</b>		11.2	6.5		3.7	3	4			77	75	70	63	52	39	25	15
	<b>Multinox 45 7</b>		14.5	8.4		4.3	4	5.5			91	88	85	77	65	50	35	21
	<b>Multinox 45 8</b>		15	8.7		5.1	5	7.5			106	103	99	92	77	60	41	26
	<b>Multinox 45 9</b>		16.3	9.4		5.6	5	7.5			116	113	109	100	86	68	47	31
	<b>Multinox 45 10</b>		18	10.4		6.2	5	7.5			129	125	120	111	97	78	57	39